

# S13

## Data sheet













Figure: S13 with design concrete  
Surface finish:  
Camina concrete paint



Figure: S13 | Surface finish: Camina concrete paint



Information  
on the wall  
structure

Standard	Total weight	Optional	Accessories		Storage concrete	Fireplace insert
 Guillotine door   Front Kristall   Rear-ventilated back wall	 approx. 650 kg	 hinged door Hinge on left / right	 SMR	 Spark protection plate	 Storage concrete	  Ekko U 67(45)51 h Nominal heat output: 9 kW Flue gas connector: Ø 200 mm  <div>  </div> Energy efficiency class as per (EU) 2015/1186  More information at <a href="http://www.camina-schmid.de">www.camina-schmid.de</a>

# S13

## Dimensional drawing

Front view, scale 1:20

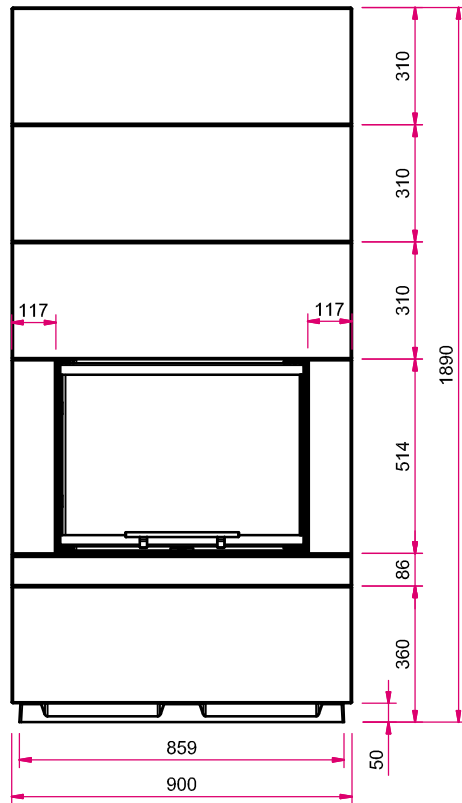

Left side view scale 1:20

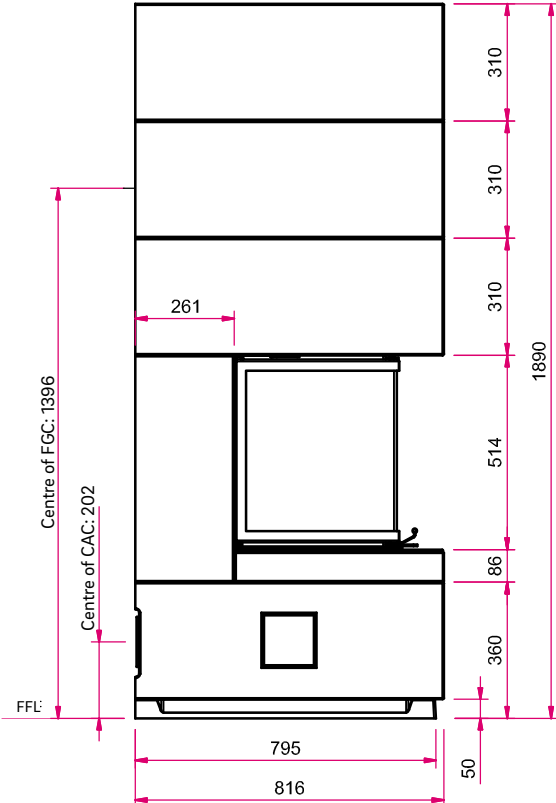

Top view, scale 1:20

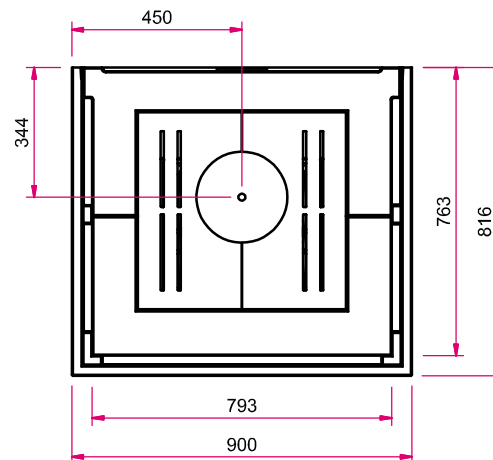

**Note on left side view scale 1:20:** AS (FGC): Flue gas connector, VLS (CAC): Combustion air connector, OKFF (FFL): Finished floor level

Please note the information on **optional accessories** in our price list.

Illustrations are similar. All photos and drawings are protected by copyright. Usage or publication, even of individual details, is only permitted with our authorisation. There may be modifications to the colour and technical details caused by ongoing developments; subject to errors and omissions. Dated: 07/2020









# S13 design concrete

## Data sheet

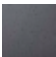

Information  
on the wall  
structure

Figure: S13 with design concrete | Surface finish: Camina concrete paint

Standard	Total weight	Optional	Accessories		Storage concrete	Fireplace insert
 <p>Guillotine door</p>  <p>Front Kristall</p>  <p>Rear-ventilated back wall</p>	 <p>approx. 650 kg</p>	 <p>hinged door Hinge on left / right</p>	 <p>SMR</p>	 <p>Spark protection plate</p>	 <p>Design concrete</p>	 <p>Ekko U 67(45)51 h Nominal heat output: 9 kW Flue gas connector: Ø 200 mm</p> <div>  <p>Energy efficiency class as per (EU) 2015/1186</p> </div> <p>More information at <a href="http://www.camina-schmid.de">www.camina-schmid.de</a></p>

# S13 design concrete

## Dimensional drawing

Front view, scale 1:20

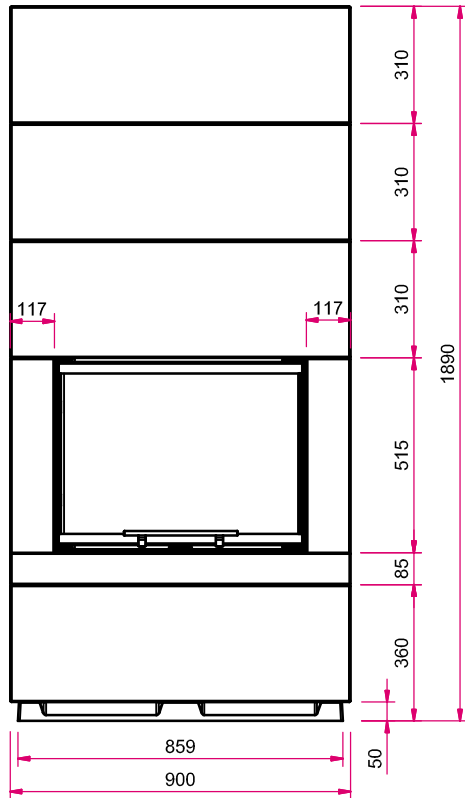

Left side view scale 1:20

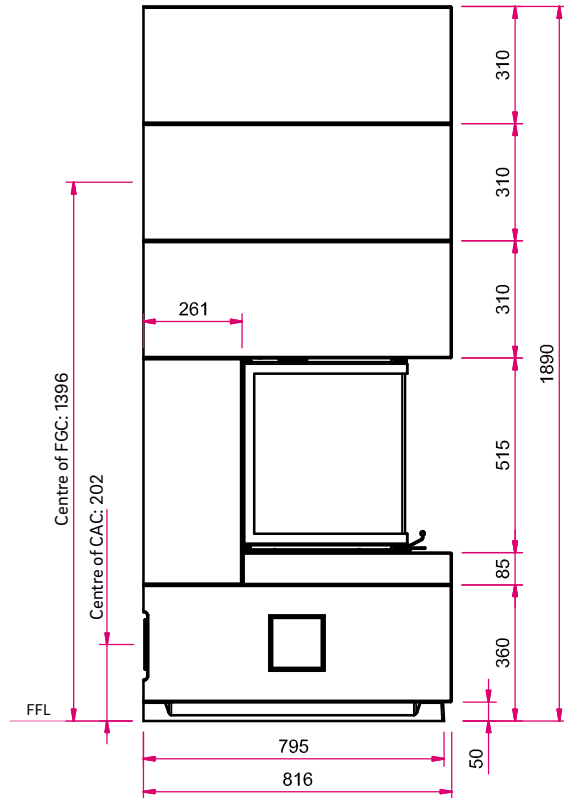

Top view, scale 1:20

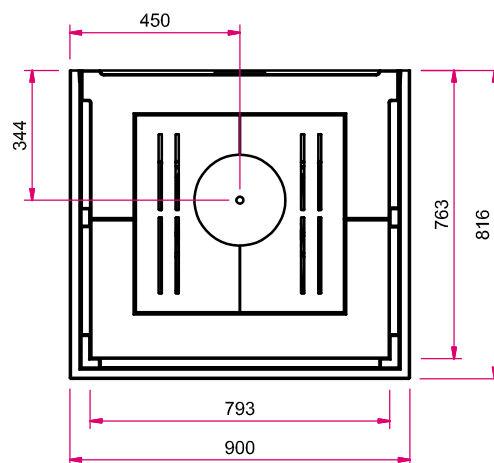

**Note on left side view scale 1:20:** AS (FGC): Flue gas connector, VLS (CAC): Combustion air connector, OKFF (FFL): Finished floor level

Please note the information on **optional accessories** in our price list.















Illustrations are similar. All photos and drawings are protected by copyright. Usage or publication, even of individual details, is only permitted with our authorisation. There may be modifications to the colour and technical details caused by ongoing developments; subject to errors and omissions. Dated: 07/2020

# S13 natural stone fire table

## Data sheet

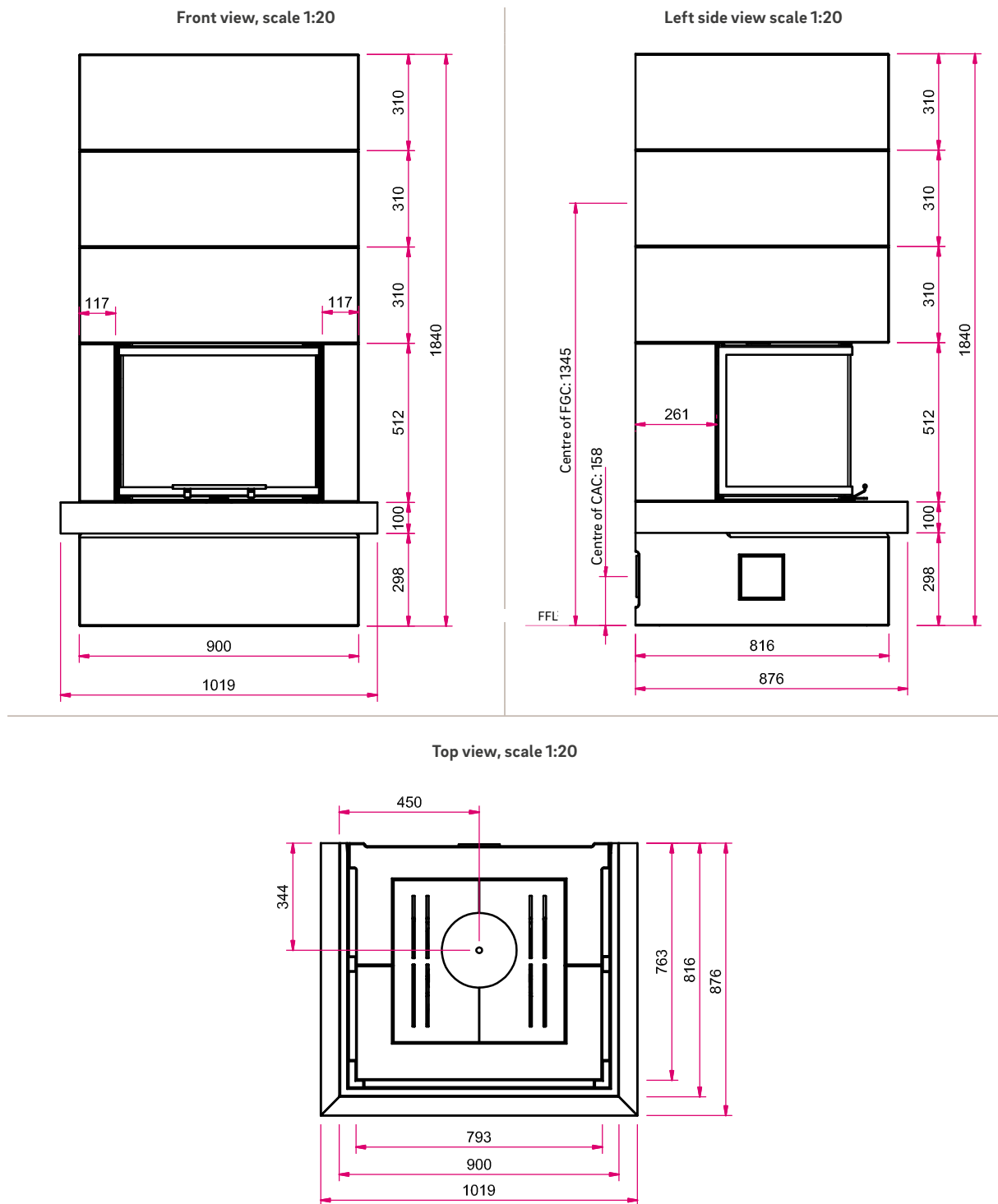

Figure: S13 with Nero matt natural stone fire table | Surface finish: Camina concrete paint

Standard	Total weight	Optional	Accessories	Natural stone	Fireplace insert
 <p>Guillotine door</p>  <p>Front Kristall</p>  <p>Rear-ventilated back wall</p>	 <p>approx. 660 kg</p>	 <p>hinged door Hinge on left / right</p>	 <p>SMR</p>  <p>Spark protection plate</p>	 <p>Blanco Carrara</p>  <p>Mocca Creme</p>  <p>Nero matt</p>  <p>Grigio matt</p>  <p>Nero</p>	 <p>Ekko U 67(45)51 h Nominal heat output: 9 kW Flue gas connector: Ø 200 mm</p> <p> A</p> <p>Energy efficiency class as per (EU) 2015/1186</p> <p>More information at <a href="http://www.camina-schmid.de">www.camina-schmid.de</a></p>

# S13 natural stone fire table

## Dimensional drawing



**Note on left side view scale 1:20:** AS (FGC): Flue gas connector, VLS (CAC): Combustion air connector, OKFF (FFL): Finished floor level

Please note the information on **optional accessories** in our price list.

Illustrations are similar. All photos and drawings are protected by copyright. Usage or publication, even of individual details, is only permitted with our authorisation. There may be modifications to the colour and technical details caused by ongoing developments; subject to errors and omissions. Dated: 07/2020

# S13 Ekko U 67(45)51 s

## Data sheet





Figure: S13 with Ekko U 67(45)51 s and design concrete  
Surface finish: Camina metal effect



Information  
on the wall  
structure

Figure: S13 with Ekko U 67(45)51 s | Surface finish: Camina metal effect

### Standard

-  hinged door  
Hinge on left / right
-  Front Kristall
-  Rear-ventilated back wall

### Total weight

 approx. 650 kg

### Optional

 Guillotine door

### Accessories

-  SMR
-  Spark protection plate

### Storage concrete

 Storage concrete

### Fireplace insert



Ekko U 67(45)51 s  
Nominal heat output: 9 kW  
Flue gas connector: Ø 200 mm

**A**

Energy efficiency class as per  
(EU) 2015/1186

More information at  
[www.camina-schmid.de](http://www.camina-schmid.de)

**S13** Ekko U 67(45)51 s  
Dimensional drawing

Front view, scale 1:20

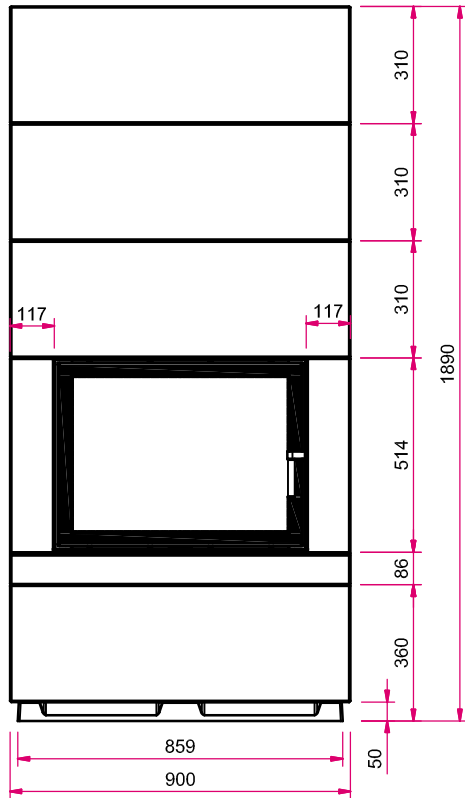

Left side view scale 1:20

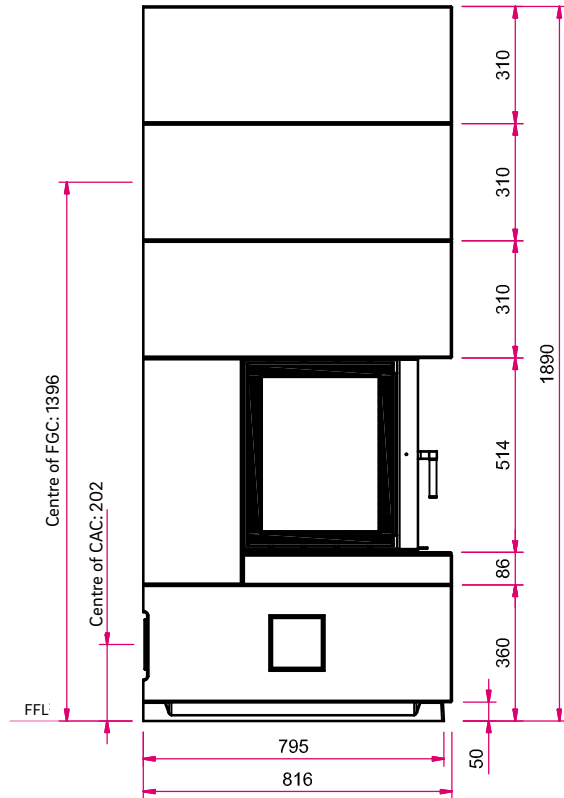

Top view, scale 1:20

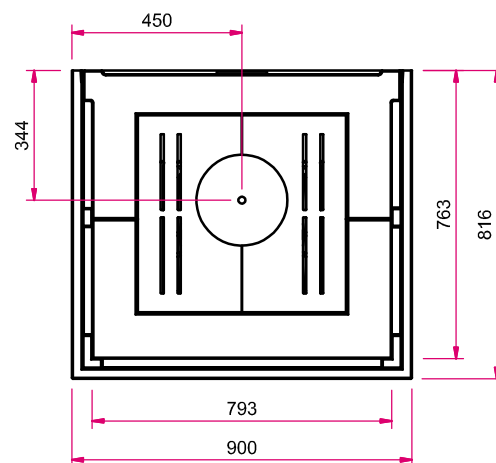

**Note on left side view scale 1:20: AS (FGC):** Flue gas connector, **VLS (CAC):** Combustion air connector, **OKFF (FFL):** Finished floor level

Please note the information on **optional accessories** in our price list.

Illustrations are similar. All photos and drawings are protected by copyright. Usage or publication, even of individual details, is only permitted with our authorisation. There may be modifications to the colour and technical details caused by ongoing developments; subject to errors and omissions. Dated: 07/2020











# S13 Ekko U 67(45)51 s and design concrete

## Data sheet

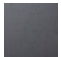

Information  
on the wall  
structure

Figure: S13 with Ekko U 67(45)51 s and design concrete | Surface finish: Camina metal effect

Standard	Total weight	Optional	Accessories		Storage concrete	Fireplace insert
 hinged door Hinge on left / right	 approx. 650 kg	 Guillotine door	 SMR	 Spark protection plate	 Design concrete	  Ekko U 67(45)51 s Nominal heat output: 9 kW Flue gas connector: Ø 200 mm
 Front Kristall						 Energy efficiency class as per (EU) 2015/1186
 Rear-ventilated back wall						More information at <a href="http://www.camina-schmid.de">www.camina-schmid.de</a>

Technical drawing of the front view of the refrigerator, showing dimensions in millimeters (mm). The total height is 1890 mm, divided into five sections: three top sections of 310 mm each, a middle section of 515 mm, and a bottom section of 360 mm. The total width is 900 mm, with a 50 mm base and 117 mm side panels. The internal width of the door is 859 mm.

Technical drawing of the front elevation of the 'CASA' cabinet. The drawing shows a white cabinet with a black door and base. The dimensions are as follows:

- Overall height: 1396 mm (Centre of FGC)
- Overall width: 795 mm
- Base height: 360 mm
- Baseboard thickness: 50 mm
- Door height: 515 mm
- Door width: 261 mm
- Section heights (from top to bottom): 310 mm, 310 mm, 310 mm, 310 mm
- Base cutout height: 85 mm
- Centre of CAC: 202 mm
- FFL (Finish Floor Level) is indicated at the bottom left.

Technical drawing of the front view of a square-shaped device. The drawing shows a central square area with a circular element in the middle, surrounded by a rectangular frame. Dimensions are indicated by pink lines and text:

- Top width: 450
- Left height: 344
- Right height: 763
- Bottom width (inner): 793
- Bottom width (outer): 900
- Far right height: 816

Please note the information on **optional accessories** in our price list.

Illustrations are similar. All photos and drawings are protected by copyright. Usage or publication, even of individual details, is only permitted with our authorisation. There may be modifications to the colour and technical details caused by ongoing developments; subject to errors and omissions. Dated: 07/2020













# S13 Ekko U 67(45)51 s and natural stone fire table

## Data sheet



Information  
on the wall  
structure

Figure: S13 with Ekko U 67(45)51 s and design Nero natural stone fire table | Surface finish: Camina silicate paint

Standard	Total weight	Optional	Accessories	Natural stone	Fireplace insert
 <p>hinged door Hinge on left / right</p>  <p>Front Kristall</p>  <p>Rear-ventilated back wall</p>	 <p>approx. 660 kg</p>	 <p>Guillotine door</p>	 <p>SMR</p>  <p>Spark protection plate</p>	 <p>Blanco Carrara</p>  <p>Mocca Creme</p>  <p>Nero matt</p>  <p>Grigio matt</p>  <p>Nero</p>	 <p>Ekko U 67(45)51 s Nominal heat output: 9 kW Flue gas connector: Ø 200 mm</p> <p><b>A</b></p> <p>Energy efficiency class as per (EU) 2015/1186</p> <p>More information at <a href="http://www.camina-schmid.de">www.camina-schmid.de</a></p>

# S13 Ekko U 67(45)51 s and natural stone fire table

## Dimensional drawing

Front view, scale 1:20

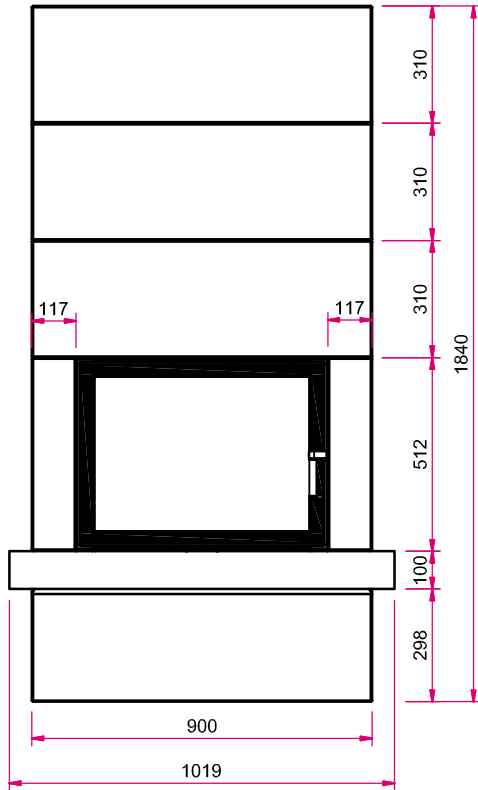

Left side view scale 1:20

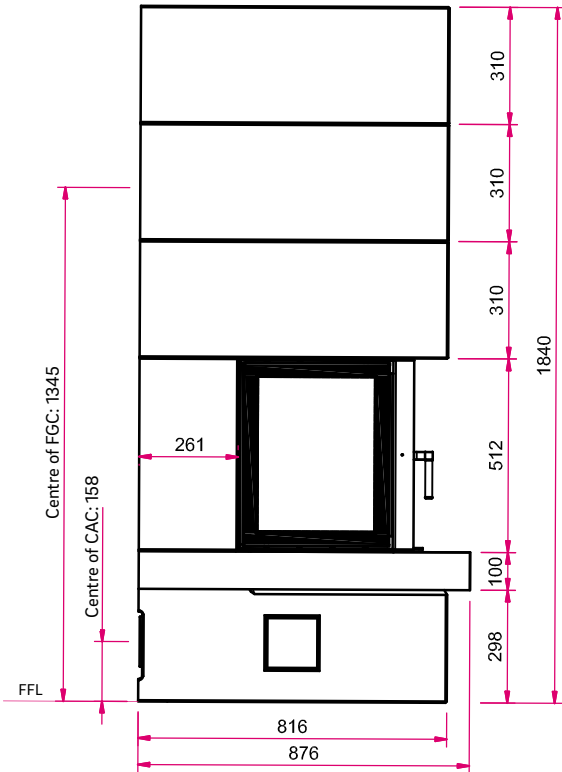

Top view, scale 1:20

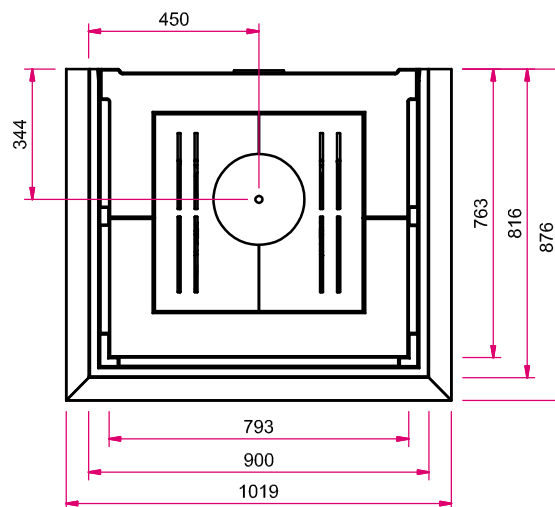

**Note on left side view scale 1:20:** AS (FGC): Flue gas connector, VLS (CAC): Combustion air connector, OKFF (FFL): Finished floor level

Please note the information on **optional accessories** in our price list.

Illustrations are similar. All photos and drawings are protected by copyright. Usage or publication, even of individual details, is only permitted with our authorisation. There may be modifications to the colour and technical details caused by ongoing developments; subject to errors and omissions. Dated: 07/2020