

# Lina GT 45 h

## Data sheet

### Details

- Fireplace insert, open on one side, minimal body depth
- 4551 – Height 51 cm  
4557 – Height 57 cm
- Optional: Self-closing door
- Adjustable lower air washing
- Standard fire box inner lining: white smooth chamotte
- High-grade cast-iron dome, all parts can be moved, adjustable between 0 – 90°
- Overall height can be simply and quickly adjusted
- Easy to dismantle for transport

### Technical data

Nominal heat output	5 kW
Thermal output range	2.4 – 5.4 kW
Efficiency	>78%
Insulation thickness (with wall that does not need to be protected) (based on SILCA® 250KM)	60 mm
Combustion air connector	Ø 125 mm
Recommend length of logs	33 cm
Weight	190 – 220 kg
Heat distribution through the viewing window	30%
Heat distribution, convective output	70%

**Data for chimney sweep** according to DIN EN 13384 (closed operation)

### Triple values with nominal heat output

Flue gas mass flow	4.7 g/s
Flue gas temperature	340 °C
Required delivery pressure	12 Pa

### Triple values for calculating ceramic flues (wood fuel)

Firing power	18.3 kW
Flue gas mass flow	13.0 g/s
Flue gas temperature upstream of the connecting surface	347 °C
Required delivery pressure at the flue gas connector	15 Pa
Combustion air requirement	73.0 m³/h
Recommended flue length <sup>1</sup>	3.5 m

### Data for closed design

Minimum heat-emitting surface <sup>2</sup>	3.6 m²
--	--------

<sup>1</sup>The information regarding flue lengths is a recommendation and based on the calculation in accordance with TROL 2022 chapter 15. The calculation is based on a medium-heavy design and a flue ratio of 360 cm².

<sup>2</sup>Average value based on the storage time. Dependent on the material properties and the construction thickness. Mean specific heat distribution = approx. 500 W/m²

There may be modifications to the colour and technical details caused by ongoing developments; subject to errors and omissions. Dated: 08/2025



Lina GT 45 with guillotine front

### Standard



Kristall front



Guillotine door



125 mm  
Combustion air connector

### Optional



Double glazing



150 mm  
Combustion air connector



External fuel-door



Frame

### Accessories



Adera



Energy efficiency class in accordance with (EU) 2015/1186



1. Federal Emissions Control Ordinance Stage 2



# Lina GT 45 h

## Dimensional drawing

Front view, scale 1:20

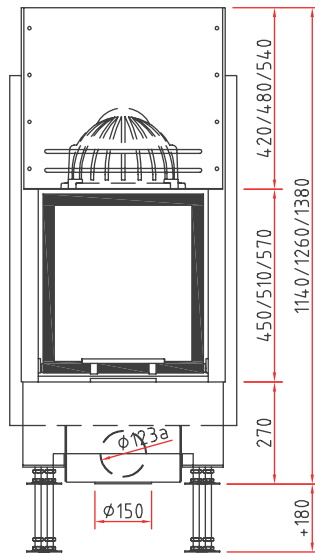

Side view, scale 1:20

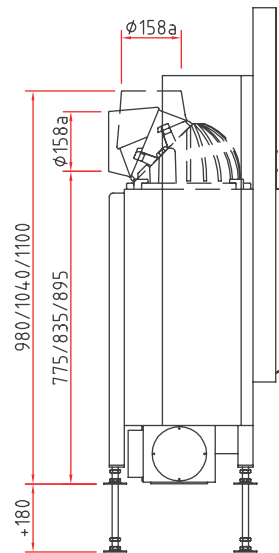

Top view, scale 1:10

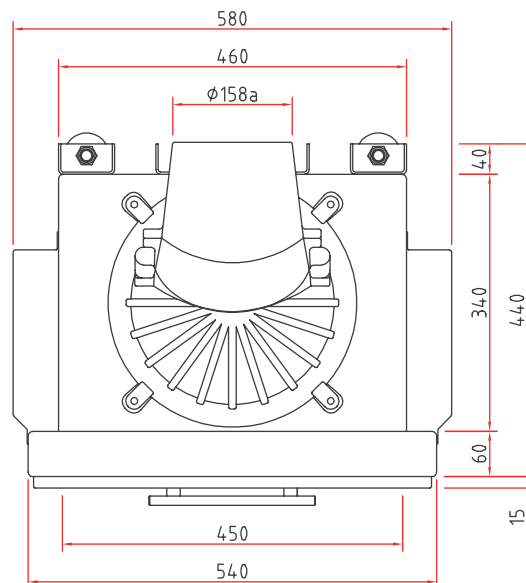

# Lina GT 4551 h

Dimensional drawing with frame system

Front view, scale 1:20

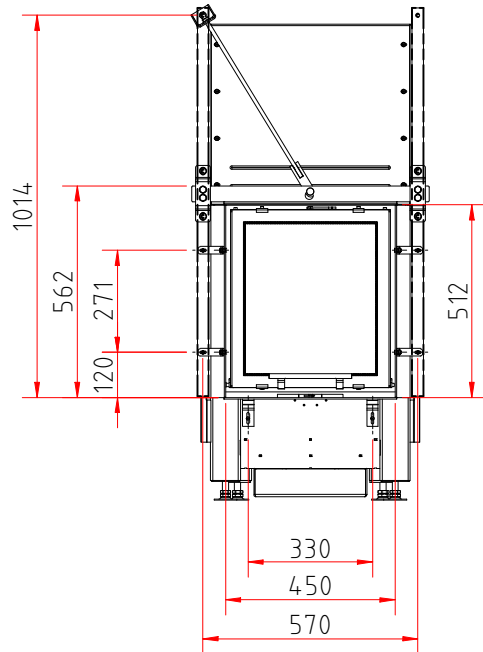

Side view, scale 1:20

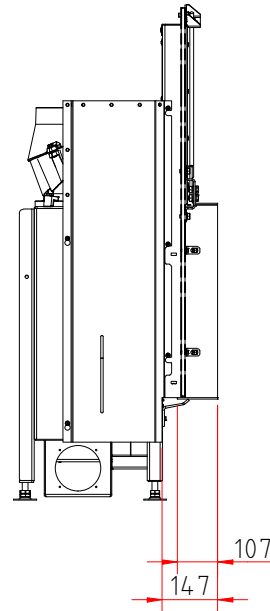

Top view, scale 1:10

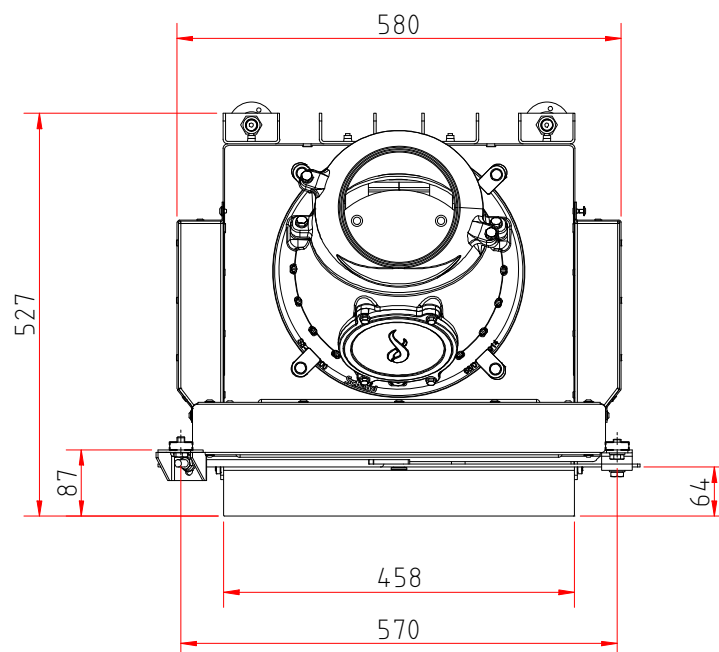

## Product data sheet

Regulation (EU) 2015/1186 supplementing Directive 2010/30/EU

	<b>Lina 45 s/h GT</b>
<b>Supplier's name:</b>	Camina & Schmid Feuerdesign und Technik GmbH & Co. KG
<b>Supplier's model identifier:</b>	Lina 45 s/h GT
<b>Energy efficiency class:</b>	A
<b>Direct heat output (kW)</b>	5,0
<b>Indirect heat output (kW):</b>	–
<b>Energy efficiency index (EEI):</b>	103,2
<b>Energy efficiency at nominal heat output (%):</b>	78,1
<b>Notes for specific precautions, installation or maintenance:</b>	Please note the reference in the assembly instructions and operating manuals!

*There may be modifications to technical details caused by ongoing developments; subject to errors and omissions. Dated: 11/2021*



ENERG  
енергия · ενέργεια



Camina  Schmid Lina 45 s/h GT

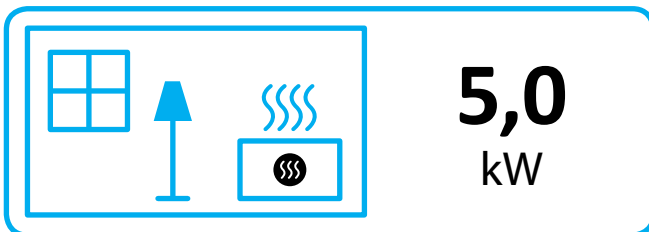
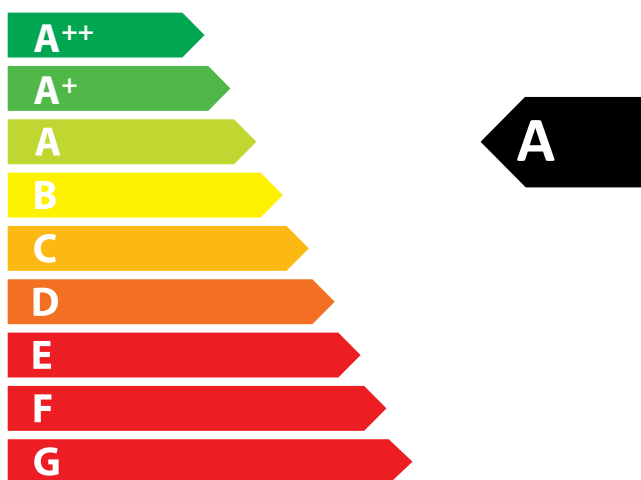

ENERGIA · ЕНЕРГИЯ · ΕΝΕΡΓΕΙΑ · ENERGIJA · ENERGY · ENERGIE · ENERGI

2015/1186