

# Ekko 34(34) h

## Data sheet

### Details

- Fireplace insert, open on two sides
- Glass: 1-section
- 34(34)51 – Height 51 cm  
34(34)57 – Height 57 cm
- Self-closing door
- Standard fire box inner lining: Caloceram®
- High-quality steel dome

### Technical data

|   |                  |
|---|------------------|
| Nominal heat output   | 7 kW             |
| Thermal output range  | –                |
| Efficiency  | >80 %            |
| Insulation thickness (with wall that does not need to be protected) (based on SILCA® 250KM) | 60 mm            |
| Combustion air connector  | Ø 125 mm         |
| Recommend length of logs  | 33 cm (standing) |
| Weight  | 90 – 110 kg      |
| Heat distribution through the viewing window  | 50 %             |
| Heat distribution, convective output  | 50 %             |

**Data for chimney sweep** according to DIN EN 13384 (closed operation)

### Triple values with nominal heat output

|                            |         |
|----------------------------|---------|
| Flue gas mass flow         | 6,4 g/s |
| Flue gas temperature       | 275 °C  |
| Required delivery pressure | 12 Pa   |

### Triple values for calculating ceramic flues (wood fuel)

|   |       |
|---|-------|
| Firing power  | –     |
| Flue gas mass flow                                      | –     |
| Flue gas temperature upstream of the connecting surface | –     |
| Required delivery pressure at the flue gas connector    | –     |
| Combustion air requirement                              | –     |
| Recommended flue length <sup>1</sup>                    | 1,7 m |

### Data for closed design

|  |                    |
|--|--------------------|
| Minimum heat-emitting surface <sup>2</sup> | 3,3 m <sup>2</sup> |
|--|--------------------|

<sup>1</sup>The information regarding flue lengths is a recommendation and based on the calculation in accordance with TROL 2022 chapter 15. The calculation is based on a medium-heavy design and a flue ratio of 360 cm<sup>2</sup>.

<sup>2</sup>Average value based on the storage time. Dependent on the material properties and the construction thickness. Mean specific heat distribution = approx. 500 W/m<sup>2</sup>

There may be modifications to the colour and technical details caused by ongoing developments; subject to errors and omissions. Dated: 08/2025



Ekko 34(34) with guillotine front

### Standard



Kristall front



Guillotine door



Combustion air connector

### Optional



Frame



Support frame system



Energy efficiency class in accordance with (EU) 2015/1186



1. Federal Emissions Control Ordinance Stage 2



# Ekko 34(34) h

## Dimensional drawing

Front view, scale 1:20

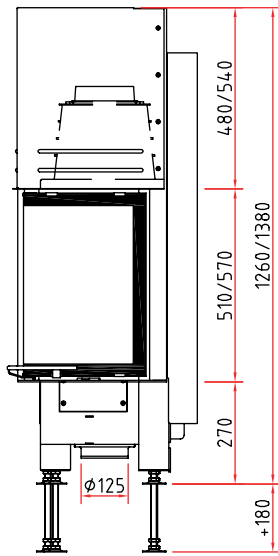

Side view, scale 1:20

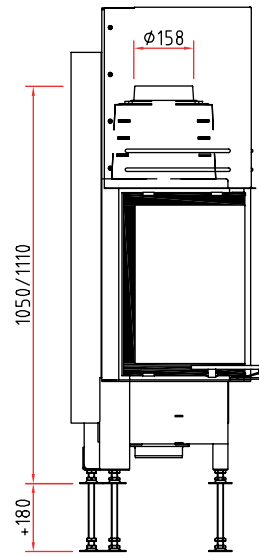

Top view, scale 1:10

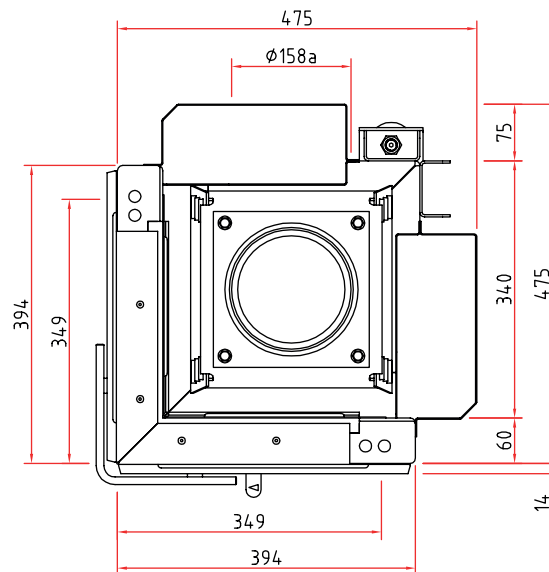

# Ekko 34(34)51 h

Dimensional drawing with frame system

Front view, scale 1:20

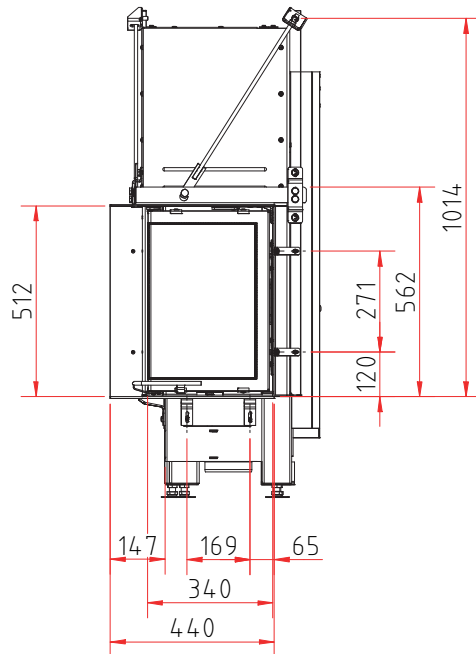

Side view, scale 1:20

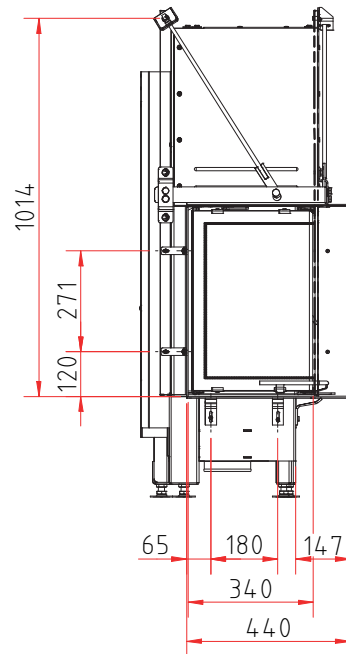

Top view, scale 1:10

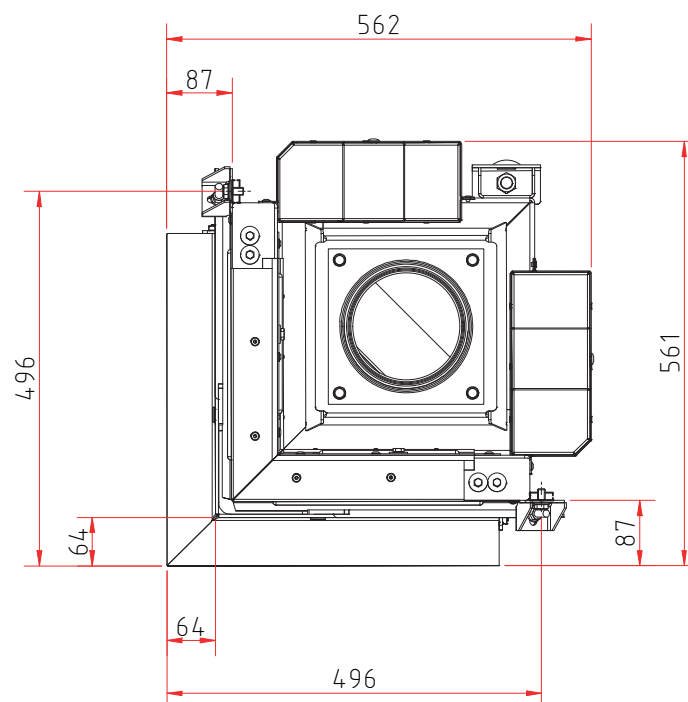

Illustrations are similar. All photos and drawings are protected by copyright. Usage or publication, even of individual details, is only permitted with our authorisation. There may be modifications to the colour and technical details caused by ongoing developments; subject to errors and omissions. Dated: 12/2023

## Product data sheet

Regulation (EU) 2015/1186 supplementing Directive 2010/30/EU

|   | <b>Ekko 34(34)</b>  |
|---|---|
| <b>Supplier's name:</b>   | Camina & Schmid Feuerdesign und Technik GmbH & Co. KG                         |
| <b>Supplier's model identifier:</b>                                 | Ekko 34(34)   |
| <b>Energy efficiency class:</b>                                     | A+  |
| <b>Direct heat output (kW)</b>                                      | 7,0   |
| <b>Indirect heat output (kW):</b>                                   | –   |
| <b>Energy efficiency index (EEI):</b>                               | 110,4   |
| <b>Energy efficiency at nominal heat output (%):</b>                | 83,0  |
| <b>Notes for specific precautions, installation or maintenance:</b> | Please note the reference in the assembly instructions and operating manuals! |

*There may be modifications to technical details caused by ongoing developments; subject to errors and omissions. Dated: 11/2021*



ENERG  
енергия · ενέργεια



Camina  Schmid Ekko 34(34)



**A<sup>+</sup>**

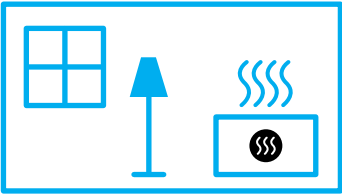

**7,0**  
kW

ENERGIA · ЕНЕРГИЯ · ΕΝΕΡΓΕΙΑ · ENERGIJA · ENERGY · ENERGIE · ENERGI

2015/1186